



Part No. Charger:
B84192B



Part No. Li-ion battery:
BB180C-315

Part No. Power cord:
E86B-VD European style
E86B-VD UK style

Charger & Li-ion battery

Attaching or Removing Battery Pack

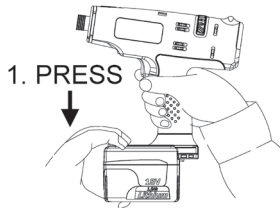
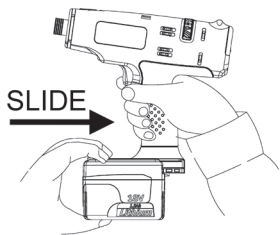

2. RELEASE ←

1. To connect battery, line up the tracks and attach the battery pack. Slide toward the battery pack until it locks into position with a click.

2. To remove the battery pack, press the red button on the top of the battery pack and release the battery pack.

Battery features:

- 18 Volt, 1,5 Ah, compact size for eas of handling.
- Adopting with the innovative Lithium-ion battery technology that extends the operating time of one full charged battery to be longer than the Ni-Cad and the Ni-MH battery.
- Lithium-ion battery has no memory effect which extends the cycle life of the battery.
- The unique design of low battery warning that reminds operators the time to change the battery.

Tool models



Type	Volt.	Drive size	Screw size	Torque range	Free speed	Weight w/o Batt.
	V	in	mm	Nm	RPM	kg
RRI-BS3	18	1/4" Hex	M3-M4	0,8-3	500-1.550	0,95
RRI-BS6	18	1/4" Hex	M3-M5	1-6	300-900	0,95
RRI-BS9	18	1/4" Hex	M3-M5	1,5-9	300-700	0,95
RRI-BS12	18	1/4" Hex	M4-M6	2-12	250-550	0,95

Choose:

- High speed for metallic assemblies
- Medium speed for plastic assemblies
- Low speed for special assemblies (like hose clamp etc.)

CORDLESS SHUT-OFF SCREWDRIVER

RRI-BS Serie



- Brushless motor
- 18 Volt Lithium-Ion battery
- Led status indicates OK-NOK-REVERSE-BATTERY LOW
- Adjustable torque
- Speed 250 to 1.550 RPM
- Compact and light weight



Back panel LED-indications



- A green light tells the operator that the preset torque is reached and the tightening is OK.
- A red light and one long "beep" sound tell the operator that the preset torque is not reached, the screwing fastener must be performed again.
- A flashing yellow light and five short "beep" sounds give an early warning when it is time for recharging in the battery.
- A yellow light and one long "beep" sound mean a battery lock that indicates the tool can't work and MUST change the battery pack immediately.

Programmer



Features:

- One programmer fits all RRI-BS series tools
 - Easy to set the tool speed:
 - High speed for metallic assemblies
 - Medium speed for plastic assemblies
 - Low speed for special assemblies
 - Total used time memory function
 - Total count memory function
 - Operation count memory function
 - Tool identification number
- (All memory functions stored on printed circuit board in the tool)

Torque adjustment

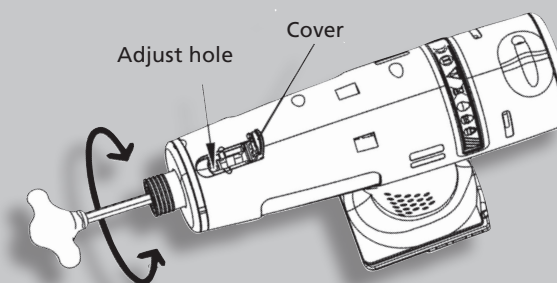

1. Lift the torque adjustment over.

Take the torque adjust tool and insert it to the quick change holder and turn until the adjust hole shows up.

Note: To avoid danger during the adjustment process, the battery pack must be removed before adjusting the torque.

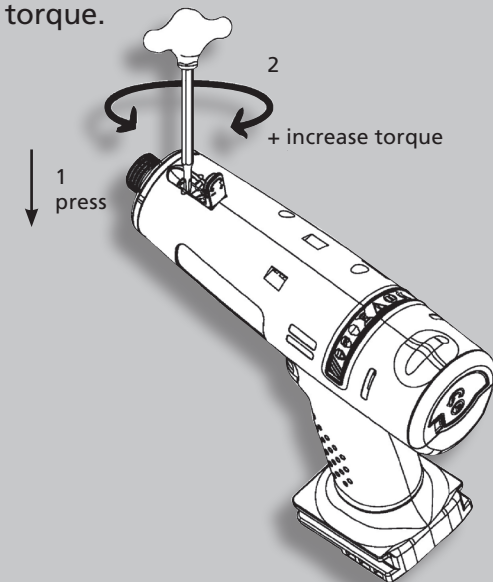

2. Use the torque adjust tool to turn clockwise to increase torque and turn counterclockwise to decrease torque.

Possibility of four rings with different colours to distinguish the torque: Colour coding of your tools made easy working!



Product Strengths

- The ergonomic handle design makes work easier and effort-saving that promotes the work efficiency.
- Torque accuracy: Meet ISO 5393 Cmk>2 at $\pm 10\%$ tolerance.
- Precision clutch with low reaction forces.
- Trigger repeat protection avoids "double hits".
- Brushless motor: Ensures low maintenance.
- Highly durable gear: Ensures low maintenance.
- Precision shut-off clutch: Ensures quality in tightening.
- Ergonomic rubber grip: Ensures operator performance.
- Delivery includes hanger bracket.

Applications



- Assembly applications where torque accuracy is required.
- Areas where pneumatic or electric tools are impractical to use due to hoses/cables.
- Especially used on car interior assembly.
- Attaching components to the dashboard.
- Hose clips on turbo chargers and air intakes, heating and climate systems and coolant circuits.

